

FDGB MMAG

K18-C 07/2013

Bipolar beginning and end of range switch

PRODUCT PRESENTATION

To indicate the open or closed position of the fire damper blade, the mechanism can be provided with bipolar end and beginning of range switch FDCB MMAG.

LIST OF PIECES

Description	Characteristics	Number
Printing plate	FDCB MMAG	1
Spacer clips	ASBM-N-11	2
Label "KIT" (yellow)	ETIK-D042	1
Large cable gland	PG13	1

DETAILED CHARACTERISTICS

	FDCB MMAG
Position switches	1mA...3A, DC 5V...AC 250V
Cable entrance	PG13
Ambient temperature	-30°C up to 50°C
Maintenance	Maintenance free

ELECTRICAL WIRING DIAGRAM

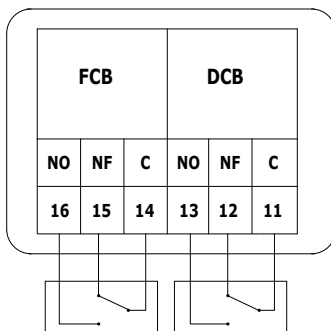

FCB: Bipolar end of range switch (option)

DCB: Bipolar beginning of range switch (option)

APPLICATION

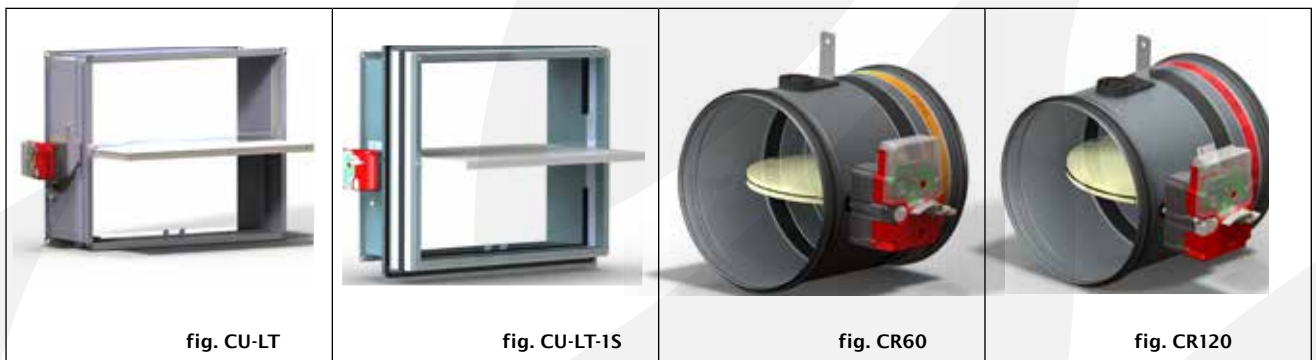

fig. CU-LT

fig. CU-LT-1S

fig. CR60

fig. CR120



OPERATION

MMAG

Manual rearmament (standard MMAG):

Turn the rearmament handle (1) clockwise or use a hex key 10

Motorized rearmament (kit ME MMAG):

1. Switch off the power supply for at least 10 sec.
2. Supply the actuator for at least 30 sec. (respect the prescribed voltage and polarity).
3. The rearmament stops automatically if a torque is detected > 15 Nm

! Switch off the power supply after rearmament.
! Switch off the power supply for at least 15sec. in between each rearmament cycle.

Manual unlocking (standard MMAG):

Use the unlocking button (2)

Remote controlled unlocking (kit VM/VD MMAG FDCU):

By sending an electrical impulse (VD) or by interrupting the power supply to the magnet's entrance of the FDCU printing plate

Automatic unlocking (standard MMAG):

When the fusible link melts at 72° C

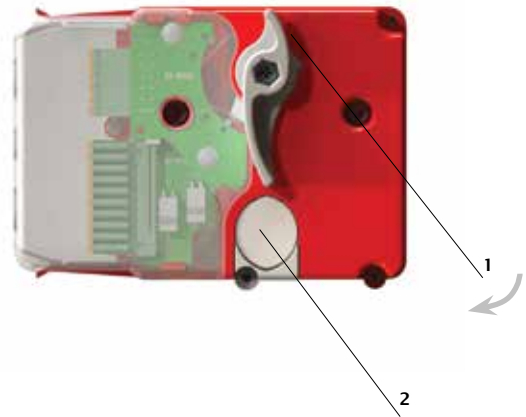

MOUNTING AND DISMANTLING

Dismantling of the switch

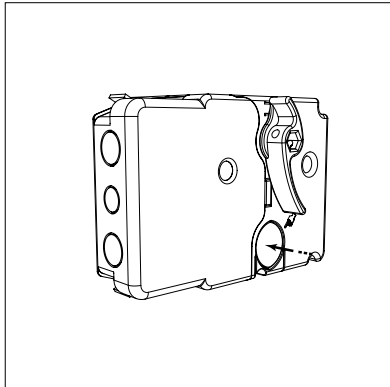

1. Unlock the actual mechanism.

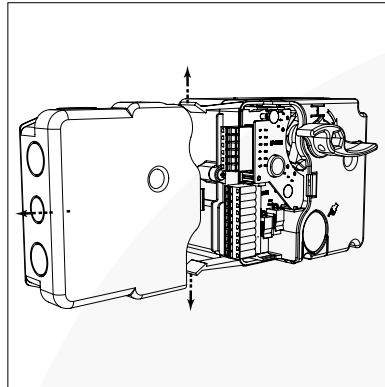

2. Untight the cover by unclicking it and then remove it.

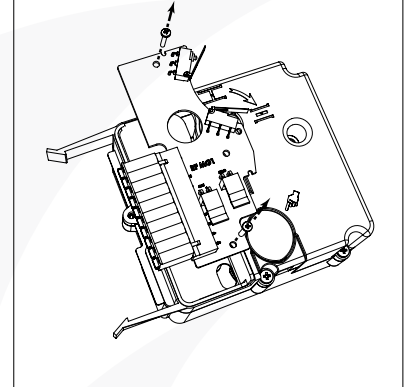

3. Remove both circuit boards.

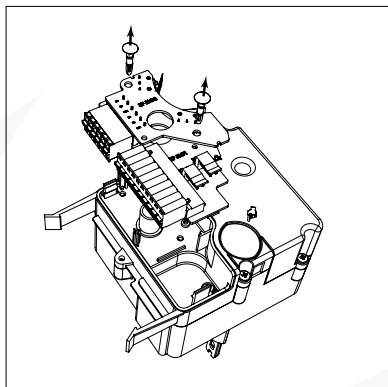

4. Remove the FDCB circuit board and replace the FDCU circuit board.



Mounting of the switch

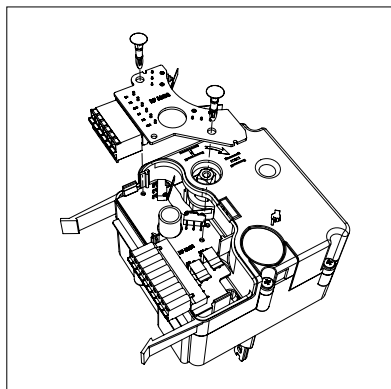

5. Mount the new FDCB circuit board in the predestined place and tighten up by clicking it by means of the enclosed clips.

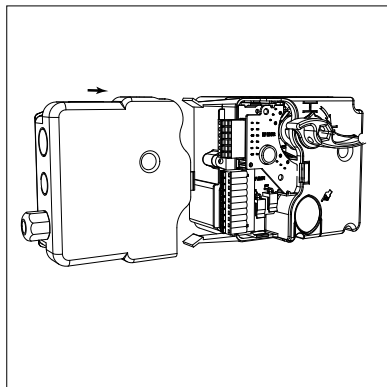

6. Mount the cable gland in the cover, make the electrical connections and mount the cover on the cap by clicking it.

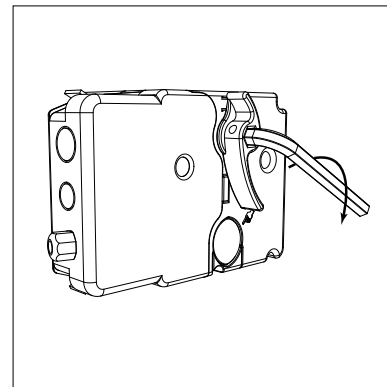

7. Test the good functioning of the mechanism.
8. Attach the label 'KIT' and fill in the necessary information.

If the damper is manipulated in any other way than described in this manual, Rf-Technologies will decline any responsibility and the guarantee will immediately expire!